

Enquiry N°:

Created by: DB / Checked by: PP

SERVO MOTOR 089LDC10XFGCJG100620-SGV3

AGV Solution Motor + Gearbox + Brake

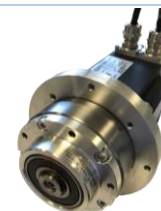

Definition

Type	Unimotor HD	
Frame Size (mm)	089	
Voltage	L	40-50V DC
Magnet type	D	D - High dynamic
Frame Length	C	
Speed (min-1)	10	1000 @ 48V
Brake	X	Braked
Connection type	F	Integrated Flying Cable
Output shaft	G	Integrated Gearbox Shaft
Feedback device code	CJ	CJ – Renco R35i encoder 4096 5PP push-pull comms
Inertia & thermistor	G	G – standard inertia + no thermistor
PCD (Gbox)	100	100 (Gear box)
Shaft Diameter	620	G BOX output
Insulation class	F	
UL Motor / UL Stator	UL Stator	

Nominal characteristics

Motor Ambient Temperature (°C)	0 to 40	Motor Ambient Storage Temperature (°C)	-15 to 40
Motor Peak Torque (Nm)	24		
Motor Stall Torque (Nm)	8	Stall Current	19.1
Rated Torque (Nm)	7.8	Rated Current (A)	18.7
Rated Power (kW) @ 48V	0.8		
Winding Thermal Time Constant (s)	98	Kt (Nm/A)	0.42
Number of Poles	10	Ke (V/kmin-1)	25.6
Maximum Cogging (Nm)	0.12	R (ph-ph) (Ohm)	0.14
Inertia Motor + GBox (kg.cm ²)	8	L (ph-ph) (mH)	1.10
Ingress Protection Level (IP)	54	Weight (kg) Motor + gearbox	6.5
Brake	06 Type	Static Torque (N.m)	4
Release Time (ms)	<150ms	Backlash (°)	TBA
Brake Supply Voltage (V)	24	Brake Coil Power (W)	15

Torque / speed graph

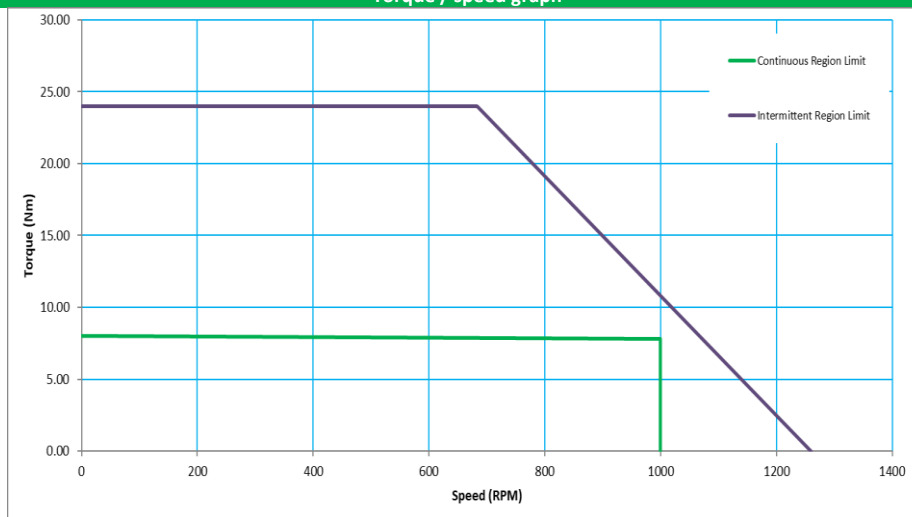

Enquiry N°:

Created by: DB / Checked by: PP

SERVO MOTOR 089LDC10XFGCJG100620-SGV3

Motors (° & mm)

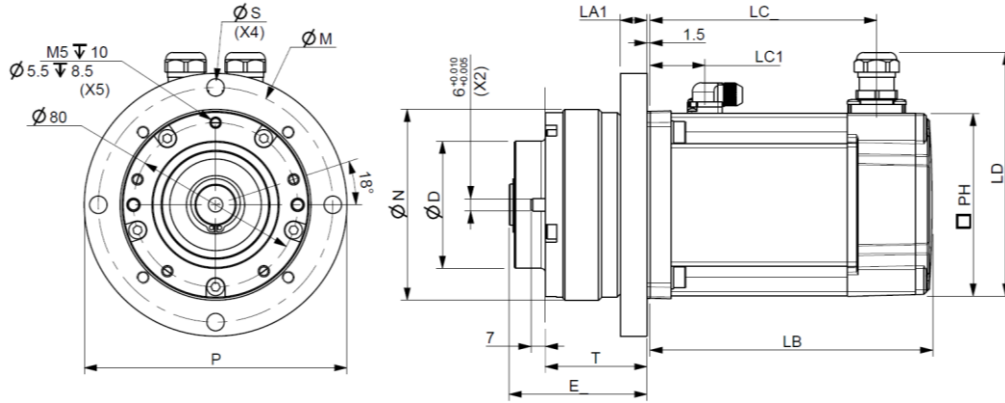

LB	Motor Total length	197.8±1
LC	Gland position	118.7±1
LA1	Flange thickness	13±0.1
T	Register Length	49.5±0.1
N	GBox Clearance Dia	93 h7
LD	Connector overall height	118
P	Flange GBox Dia	128
S	Fixing Hole Diameter	8.5
M	Fixing hole PCD	114.3
PH	Motor Housing Width	89±0.3
E	GBox Length	67.2
D	GBox Register Diameter	62±0.07
LC1	Brake Connector position	20.8±0.4
	Motor+Gbox Total Length	265
	Mounting Bolt	M8

Motor electrical interface Flying leads option:

Feedback device code:						Connection type:		
CJ – Renco R35i encoder 4096 5PP push-pull comms								
1	Red	Power	7	Yellow	CH A	1	U	Orange (x 2)
2	Green	HALL A	8		-	2	V	Red (x 2)
3	Brown	HALL B	9	Blue	CH B	3	W	Yellow (x 2)
4	White	HALL C	10			4	Earth	Green/Yellow (x 2)
5	Black	GND	11					
6	Red		12					

SIG Cable (28 AWG): 500mm (from gland to customer end) 12-Way MOLEX Connector 43025-1200	PWR Cable: 500mm (from gland to customer end) 8 cores of 18 AWG UL 1330 wire, with polyolefin heat shrink sleeve Shrouded Spade terminals fitted to lead wires
---	--

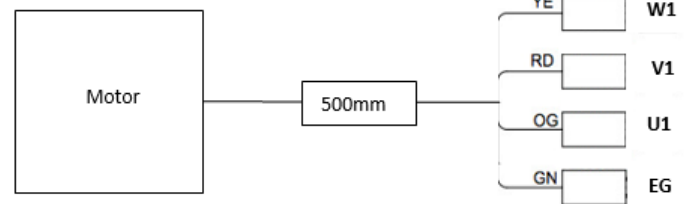
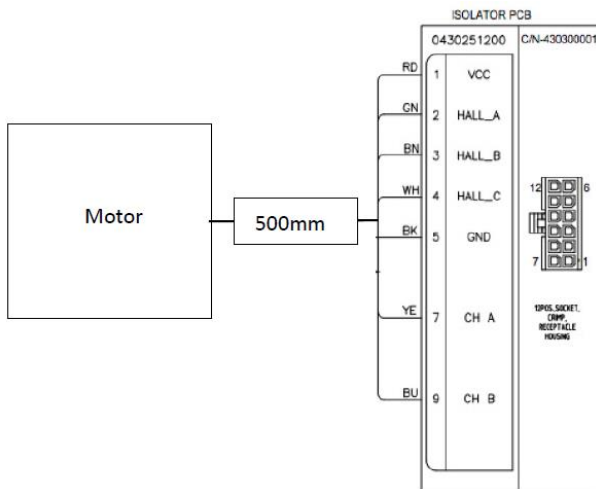

**BRAKE CONNECTOR DETAIL
2 WAY MOLEX MALE**

2W END A	FUNCTION	COLOUR
1	+VE	WHITE
2	-VE	BLACK

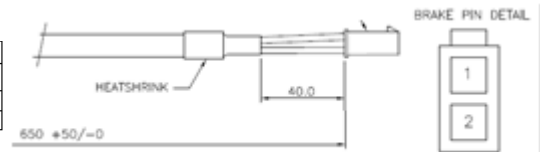

Enquiry N°:

Created by: DB / Checked by: PP

SERVO MOTOR 089LDC10XFGCJG100620-SGV3

Gear Box characteristics

Ratio	9	Backlash (arc/min)	≤7
Stages	1	Radial Load (Fr, N) @ Fa=0, Input Speed Nom	3500
Inertia (kg.cm ²)	~0.2	Radial Load MAX (Fr, N)	7250
Weight (kg)	2.7	Axial Load (Fa, N) @ Fr=0, Input Speed Nom	2200
Efficiency	95%		

